

## RESIDENTIAL SERVICES

### Pu'uhoonua (Emergency Shelters)

O'ahu - 808.754.9844

### Hale Hōkūle'a

#### Hale Huli'au (Transitional Living Program)

O'ahu - 808.589.1829 Ext. 134

### Kauhale 'Ōpio

O'ahu - 808.589.1829 Ext. 299

## PREVENTION & OUTREACH SERVICES

### Guide On The Side

O'ahu - 808.265.0635

### Independent / Interdependent Living Programs / Higher Education / Imua Kākou ('IHI)

#### Step-Up Housing & Foster Youth to Independence

O'ahu - 808.589.1829 Ext. 233

### Ka'i Like Program

O'ahu - 808.589.1829 Ext. 200 • Hawai'i - 808.969.1935

### Kalihi Juvenile Assessment Center

O'ahu - 808.336.1573

### Safe Place

O'ahu - 808.999.SAFE (7233) • Hawai'i - 808.959.5855

### Transition & Aftercare Support Services

O'ahu & Kaua'i - 808.589.1829 Ext. 200

Hawai'i & Maui - 808.969.1935

### Wraparound Services

O'ahu - 808.589.1829 Ext. 200 • Hawai'i - 808.854.9032

### Youth Outreach

O'ahu - 808.457.9907

## CLINICAL SERVICES

### Expanded Crisis Support

O'ahu - 808.589.1829 Ext. 400 • Hawai'i - 808.969.1935

### Hale Ho'opakele

O'ahu - 808.589.1829 Ext. 111

### Ho'oulu 'Ohana Wellness Center

Statewide - 808.969.1935

### Intensive In-Home Services / Intensive Independent Living Skills

O'ahu - 808.589.1829 Ext. 400

Kaua'i - 808.589.1829 Ext. 200 • Hawai'i - 808.969.1935

### Trafficking Victim Assistance Program

O'ahu, Kaua'i, Hawai'i Hotline - 1.888.398.1188

### Transitional Family Homes

O'ahu - 808.589.1829 Ext. 115

## MISSION STATEMENT

*Rooted in aloha and kuleana, Hale Kipa is dedicated to supporting and empowering Hawai'i's youth, young adults, and families who are navigating trauma, injustice, and systemic barriers. Through safe and nurturing housing, culturally grounded care, and trauma-informed relationships, we encourage them to discover their passions, embrace their resilience, and thrive as compassionate, responsible leaders in their families and communities.*

Hale Kipa is a multi-service, fully accredited 501(c)(3) nonprofit agency that specializes in working with youth and their families who often have nowhere else to turn. Hale Kipa has served more than 74,000 youth throughout Hawai'i since its beginning in 1970 as a single shelter on O'ahu.

This includes working in partnership with public agencies and private organizations to provide residential, outreach, and foster care services at no cost. With programs that are flexible and responsive to changing needs, Hale Kipa supports youth involved in juvenile justice, behavioral health, education and child welfare. Program goals include stabilizing young people in crisis and helping youth and families build resiliency to experience success in their lives. Services are flexible, free, creative, and determined by the youth's and family's needs.

All persons are treated equitably and without favoritism, subject to limitations imposed by contractual obligations.



## HALE KIPA

91-2128 Old Fort Weaver Road • 'Ewa Beach, HI 96706

T 808.589.1829 • F 808.589.2610

info@halekipa.org • www.halekipa.org



Aloha United Way  
Kauai United Way  
Hawaii Island United Way



# Transition & Aftercare Support Services



## HALE KIPA

Empowering Lives - One Youth At A Time

## Transition & Aftercare Support Services (TASS)

Transition & Aftercare Support Services provides support for youth transitioning back into the community from the Hawai'i Youth Correctional Facility and their families.

Services are based on an intensive, individualized, and strengths-based approach that focuses on the youth and family's needs and goals. Each family is assigned a Community Advocate who helps them identify and cultivate community relationships and form a network to provide support. Families receive an average of 6 hours of advocacy services each week.

Some youth and families may also participate in our wraparound services, which are provided by a facilitator, navigator and parent partner.

### Population and Eligibility Criteria

- Youth ages 12 through 18 (20 if youth is on parole)
- Transitioning out of the Hawai'i Youth Correctional Facility

### Youth and Family Responsibilities:

- Participate in the development of an individualized service plan and personal goals
- Participate in program activities, at a specific number of hours per week
- Attend school or maintain another appropriate educational or vocational plan

### Services

- Individual and group support
- Advocacy and referrals
- Comprehensive assessments
- Individualized service plan development
- Competency development for youth and parents
- Youth and family support
- Resources development
- In-school assistance
- Connections and collaboration with other community resources
- Activities (recreational, skill building, cultural tutoring, etc.)
- Twenty-four-hour staff accessibility for crisis and emergency situations

### Contact Information

O'ahu & Kaua'i – 808.589.1829 Ext. 200  
Hawai'i & Maui – 808.969.1935

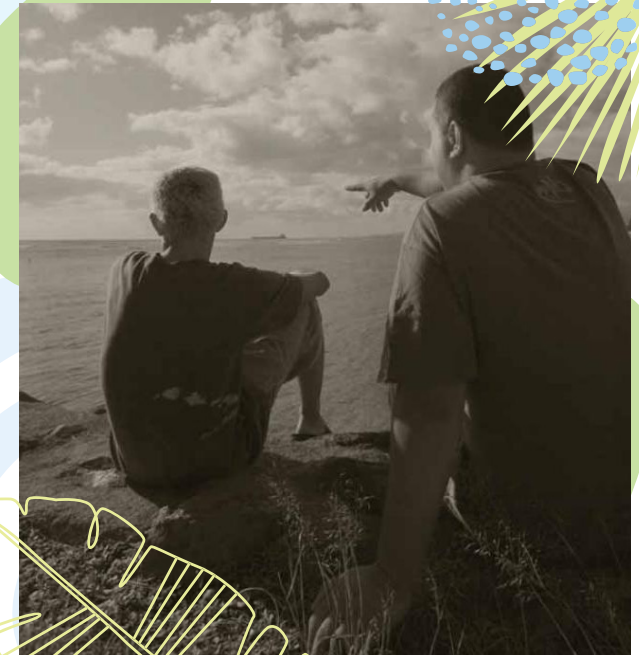

*“Hale Kipa saw a potential in me. That stuck with me all through the tough years.”*

*Jason*

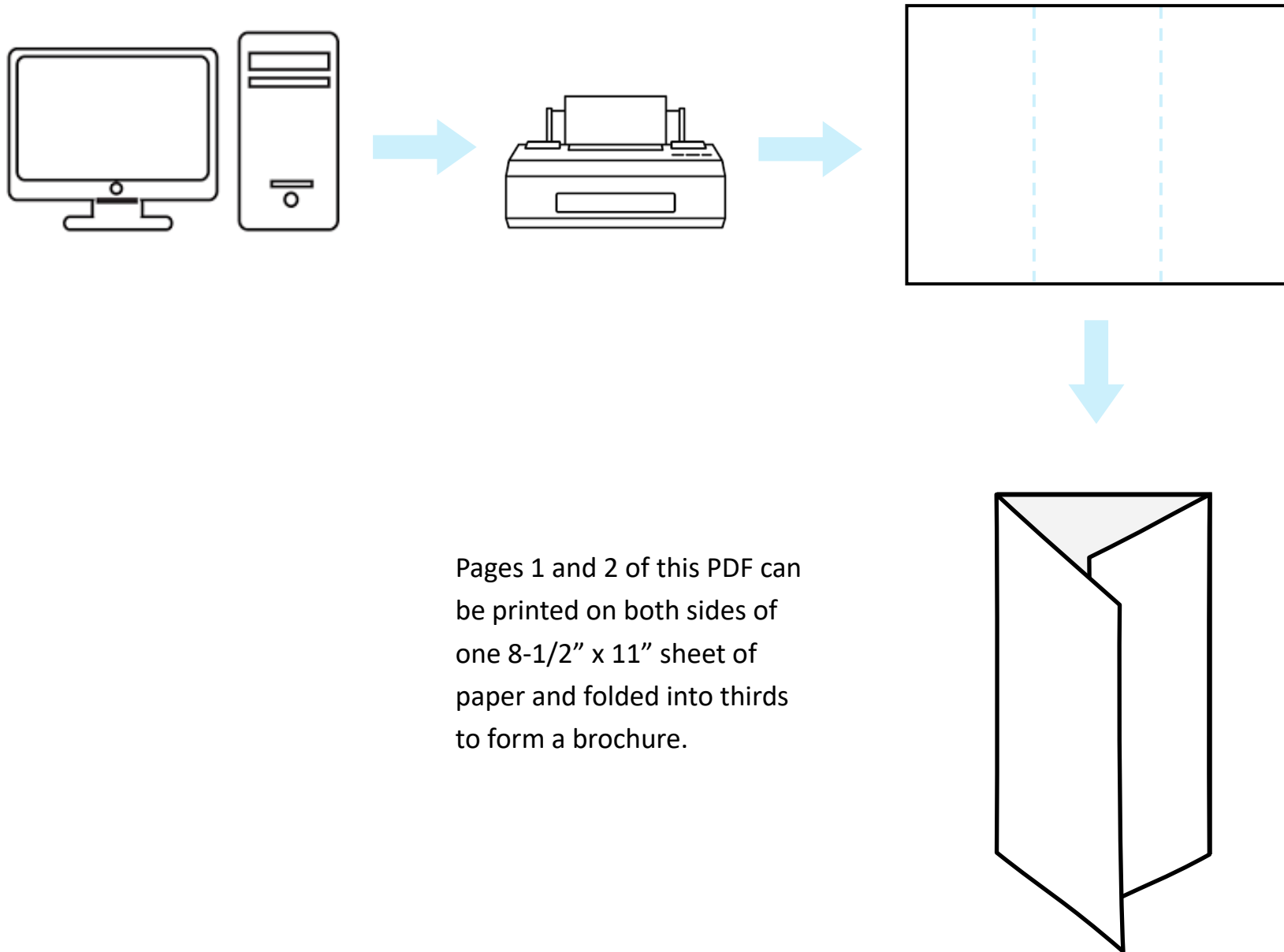

Pages 1 and 2 of this PDF can be printed on both sides of one 8-1/2" x 11" sheet of paper and folded into thirds to form a brochure.