

## Chef Partnership Survey

We are committed to growing in alignment with the needs of Hawai'i's culinary community. Your insight ensures we cultivate produce that meaningfully supports local kitchens.

We invite you to share:

- ◆ The varieties you would like us to grow
- ◆ Estimated weekly volume for your kitchen
- ◆ Preferred delivery schedule
- ◆ Price ranges you consider fair for premium, locally grown greens
- ◆ Interest in microgreens and other specialty produce

Your feedback enables us to operate sustainably while delivering chef-driven, consistent, and exceptionally fresh produce.

## Visit Our Farm

We warmly welcome chefs and culinary partners to visit our farm in 'Ewa Beach and experience firsthand how your produce is grown. Tour our controlled-environment Freight Farm, meet our team, and learn more about our commitment to quality, consistency, and sustainability.

Private tours are available by appointment.

### Melissa Zogopoulos

Farm Manager

mzogopoulos@halekipa.org

808.589.1829 Ext. 601

## MISSION STATEMENT

*Rooted in aloha and kuleana, Hale Kipa is dedicated to supporting and empowering Hawai'i's youth, young adults, and families who are navigating trauma, injustice, and systemic barriers. Through safe and nurturing housing, culturally grounded care, and trauma-informed relationships, we encourage them to discover their passions, embrace their resilience, and thrive as compassionate, responsible leaders in their families and communities.*

Hale Kipa is a multi-service, fully accredited 501(c)(3) nonprofit agency that specializes in working with youth and their families who often have nowhere else to turn. Hale Kipa has served more than 74,000 youth throughout Hawai'i since its beginning in 1970 as a single shelter on O'ahu.

This includes working in partnership with public agencies and private organizations to provide residential, outreach, and foster care services at no cost. With programs that are flexible and responsive to changing needs, Hale Kipa supports youth involved in juvenile justice, behavioral health, education and child welfare. Program goals include stabilizing young people in crisis and helping youth and families build resiliency to experience success in their lives. Services are flexible, free, creative, and determined by the youth's and family's needs.

All persons are treated equitably and without favoritism, subject to limitations imposed by contractual obligations.



# HALE KIPA

91-2128 Old Fort Weaver Road • 'Ewa Beach, HI 96706

T 808.589.1829 • F 808.589.2610

info@halekipa.org • www.halekipa.org



Aloha United Way  
Kauai United Way  
Hawaii Island United Way



 HALE KIPA

# Mahi'ai Aloha

CULTIVATING OPPORTUNITY,  
PURPOSE, AND HEALING



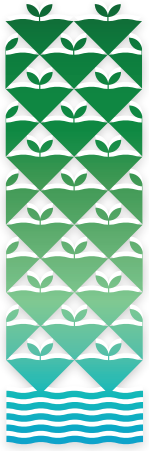

HALE KIPA

# Mahi'ai Aloha

CULTIVATING OPPORTUNITY,  
PURPOSE, AND HEALING

## Growing with Purpose Cultivating Opportunity

Mahi'ai Aloha is Hale Kipa's innovative aeroponic Freight Farm, dedicated to producing clean, vibrant greens year-round within a fully controlled growing environment. Located in 'Ewa Beach, our state-of-the-art hydroponic container farm cultivates premium, pesticide-free produce while creating meaningful educational and workforce opportunities for youth and young adults.

More than a farm, Mahi'ai Aloha is an integral part of Hale Kipa's Workforce Development Program. Through hands-on training in agriculture, food production, and farm operations, young people gain practical skills, real-world work experience, and pathways toward sustainable careers. Each harvest reflects our dual commitment: exceptional produce and empowered futures.

## Currently Available Produce

Our greens are harvested with their roots intact to preserve vitality, extend shelf life, and deliver exceptional freshness from farm to table.

### Featured Varieties:

- ◆ Signature Salad Greens
- ◆ Chef's Blend Mixed Greens
- ◆ Peppery Arugula
- ◆ Premium Lettuce Varieties

Grown in a carefully monitored, climate-controlled environment, every crop embodies our dedication to quality, consistency, and sustainability.

## Expanding Our Harvest

As we continue to grow, Mahi'ai Aloha is thoughtfully exploring new varieties to diversify our offerings and better serve our community and culinary partners.

### Future Selections May Include:

- ◆ Fragrant Basil
- ◆ Fresh Cilantro
- ◆ Specialty Culinary Herbs
- ◆ Edible Flowers
- ◆ Nutrient-Dense Microgreens

Each new crop is carefully selected to reflect our commitment to quality, innovation, and year-round freshness.



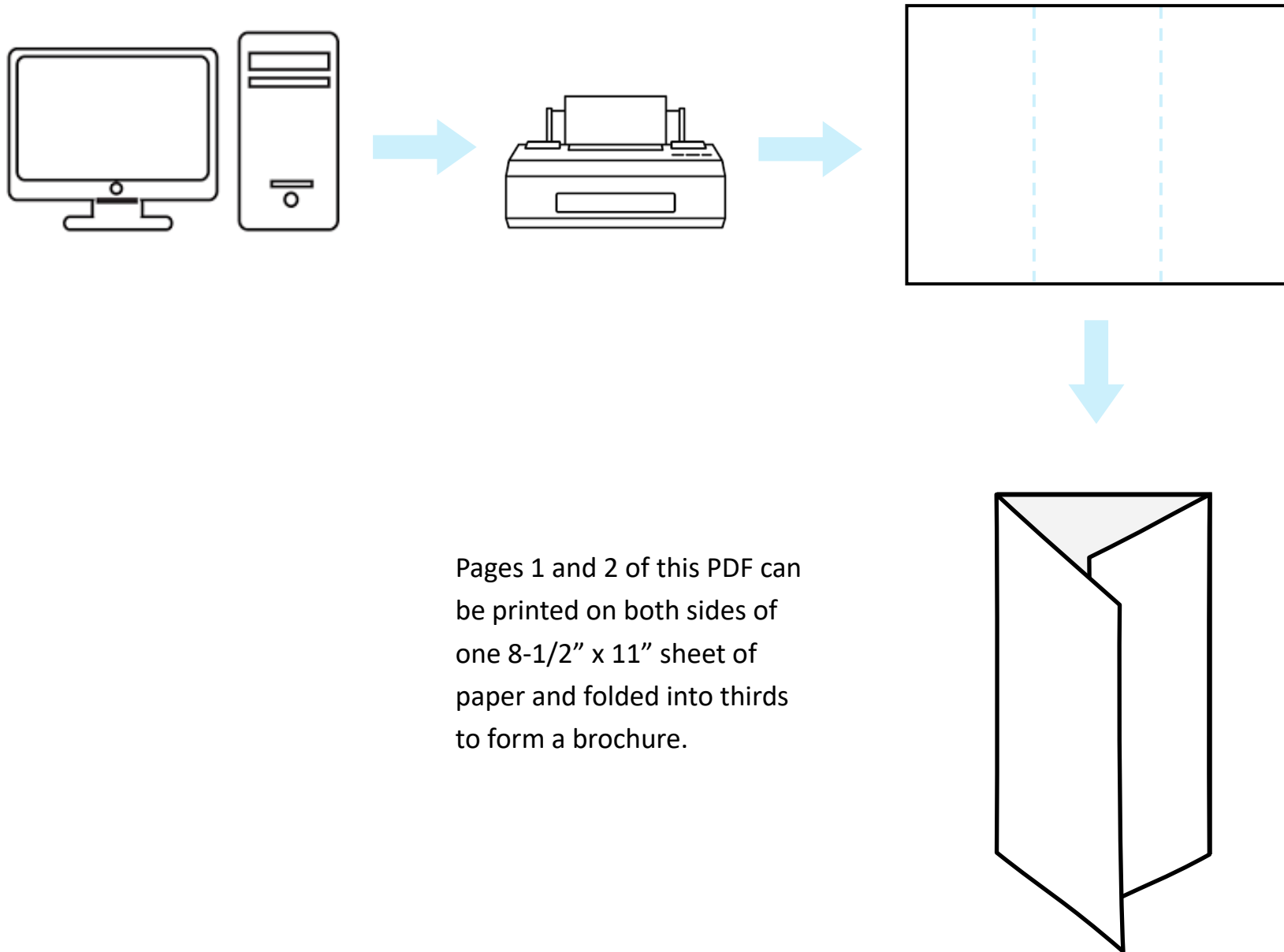

Pages 1 and 2 of this PDF can be printed on both sides of one 8-1/2" x 11" sheet of paper and folded into thirds to form a brochure.