

## RESIDENTIAL SERVICES

### Pu'uohonua (Emergency Shelters)

O'ahu - 808.754.9844

### Hale Hōkūle'a

#### Hale Huli'au (Transitional Living Program)

O'ahu - 808.589.1829 Ext. 134

### Kauhale 'Ōpio

O'ahu - 808.589.1829 Ext. 299

## PREVENTION & OUTREACH SERVICES

### Guide On The Side

O'ahu - 808.265.0635

### Independent / Interdependent Living Programs / Higher Education / Imua Kākou ('IHI)

#### Step-Up Housing & Foster Youth to Independence

O'ahu - 808.589.1829 Ext. 233

### Ka'i Like Program

O'ahu - 808.589.1829 Ext. 200 • Hawai'i - 808.969.1935

### Kalihi Juvenile Assessment Center

O'ahu - 808.336.1573

### Safe Place

O'ahu - 808.999.SAFE (7233) • Hawai'i - 808.959.5855

### Transition & Aftercare Support Services

O'ahu & Kaua'i - 808.589.1829 Ext. 200

Hawai'i & Maui - 808.969.1935

### Wraparound Services

O'ahu - 808.589.1829 Ext. 200 • Hawai'i - 808.854.9032

### Youth Outreach

O'ahu - 808.457.9907

## CLINICAL SERVICES

### Expanded Crisis Support

O'ahu - 808.589.1829 Ext. 400 • Hawai'i - 808.969.1935

### Hale Ho'opakele

O'ahu - 808.589.1829 Ext. 111

### Ho'oulu 'Ohana Wellness Center

Statewide - 808.969.1935

### Intensive In-Home Services / Intensive Independent Living Skills

O'ahu - 808.589.1829 Ext. 400

Kaua'i - 808.589.1829 Ext. 200 • Hawai'i - 808.969.1935

### Trafficking Victim Assistance Program

O'ahu, Kaua'i, Hawai'i Hotline - 1.888.398.1188

### Transitional Family Homes

O'ahu - 808.589.1829 Ext. 115

## MISSION STATEMENT

*Rooted in aloha and kuleana, Hale Kipa is dedicated to supporting and empowering Hawai'i's youth, young adults, and families who are navigating trauma, injustice, and systemic barriers. Through safe and nurturing housing, culturally grounded care, and trauma-informed relationships, we encourage them to discover their passions, embrace their resilience, and thrive as compassionate, responsible leaders in their families and communities.*

Hale Kipa is a multi-service, fully accredited 501(c)(3) nonprofit agency that specializes in working with youth and their families who often have nowhere else to turn. Hale Kipa has served more than 74,000 youth throughout Hawai'i since its beginning in 1970 as a single shelter on O'ahu.

This includes working in partnership with public agencies and private organizations to provide residential, outreach, and foster care services at no cost. With programs that are flexible and responsive to changing needs, Hale Kipa supports youth involved in juvenile justice, behavioral health, education and child welfare. Program goals include stabilizing young people in crisis and helping youth and families build resiliency to experience success in their lives. Services are flexible, free, creative, and determined by the youth's and family's needs.

All persons are treated equitably and without favoritism, subject to limitations imposed by contractual obligations.



## HALE KIPA

91-2128 Old Fort Weaver Road • 'Ewa Beach, HI 96706

T 808.589.1829 • F 808.589.2610

info@halekipa.org • www.halekipa.org



Aloha United Way  
Kauai United Way  
Hawaii Island United Way



# Expanded Crisis Support



## HALE KIPA

Empowering Lives - One Youth At A Time

## Expanded Crisis Support (ECS)

Hale Kipa's Expanded Crisis Support Program provides stabilizing supports following a mental health crisis utilizing up to 8 weeks of services that focuses on improving emotional and behavioral regulation and reducing risk to self and others by assisting with crisis planning; engaging in short-term therapeutic interventions; and providing case management to link with more long-term resources, such as CAMHD services, or other outpatient community providers. The services are based on an intensive, individualized, strengths-based approach that focuses on stabilizing crisis situations and crisis prevention skills for the youth and their families.

A dedicated, geographically-based team of senior therapists are assigned to assist and support young persons and their families to meet the identified goals of their Service Plan by supporting youth and families in managing and preventing crisis. Upon discharge, youth will be linked with formal and/or informal supports to support their mental health and wellbeing. Services are designed to be both culturally sensitive and developmentally fitting to the strengths and needs of youth and their families.

## Admission Criteria

- Youth must be between the ages of 3 and 20
- Youth must have experienced a mental health crisis in the last 30 days
- Youth and family agree to participate in the service
- Youth must not have CAMHD services at this time

## Youth and Family Responsibilities

- The family/guardian(s) agree to active involvement in treatment and the youth is willing to participate
- Participation in the development of an individualized Service Plan with personal goals
- Participation in individualized program activities and services

## Services

- Up to 8 weeks of therapeutic interventions that are family and youth-centered
- Flexibility to meet with youth and families in a variety of home and community locations
- Weekly assistance for families to identify and secure other services and resources as needed
- Service Plans are developed based on the strengths and goals of the individual and family
- Assist families and youth to obtain relevant skills which leads toward stabilizing crisis situations and crisis prevention
- Linkages and collaboration with other community resources
- 24-hour staff accessibility / crisis planning and interventions

## Contact Information

O'ahu – 808.589.1829 Ext. 400  
Hawai'i – 808.969.1935



*“I appreciate everything you do for me and for you taking the time to work with me and help me through this situation.”*

*Lani, age 16*

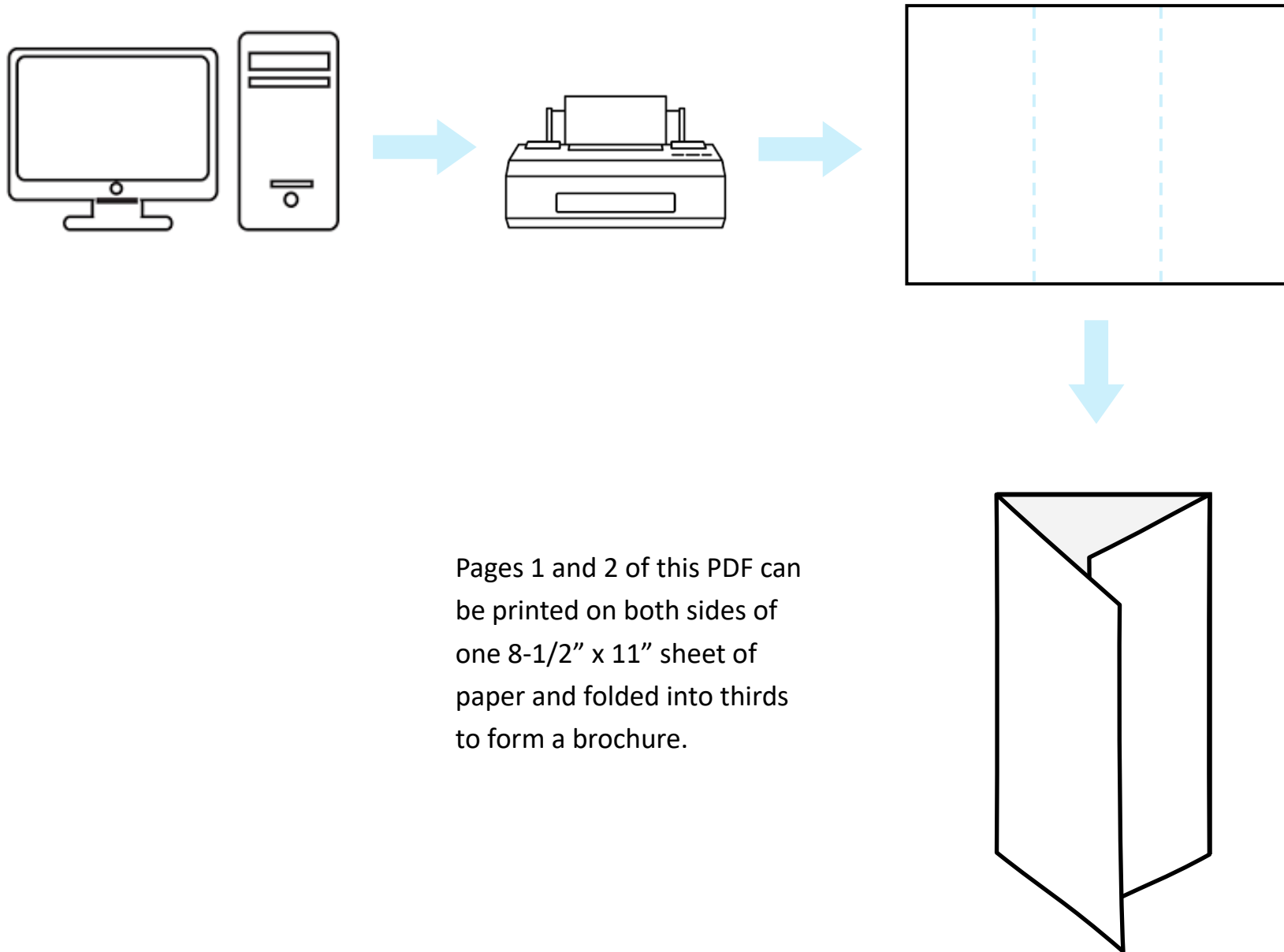

Pages 1 and 2 of this PDF can be printed on both sides of one 8-1/2" x 11" sheet of paper and folded into thirds to form a brochure.