

## RESIDENTIAL SERVICES

### Emergency Shelters (ES) / Kamala Homes (KH)

O'ahu - 808.754.9844

### Hale Ho'opakele

O'ahu - 808.589.1829 Ext. 111

### Hāloa House

### Independent Living Program Training Home (ILPTH)

### Transitional Living Program (TLP)

O'ahu - 808.589.1829 Ext. 134

### Kauhale 'Ōpio

O'ahu - 808.589.1829 Ext. 299

## PREVENTION & OUTREACH SERVICES

### Community-Based Outreach & Advocacy Programs (CBOA)

O'ahu & Kaua'i - 808.589.1829 Ext. 200

### Guide On The Side (GOTS)

O'ahu - 808.265.0635

### Ho'okala Attendant Care Program

O'ahu - 808.589.1829 Ext. 160

### Independent Living Programs / Higher Education / Imua Kākou ('IHI)

### Step-Up Housing & Foster Youth to Independence (FYI)

O'ahu - 808.589.1829 Ext. 233

### Ka'i Like Program

O'ahu - 808.589.1829 Ext. 200 • Hawai'i - 808.969.1935

### Kalihi Juvenile Assessment Center (KJAC)

O'ahu - 808.336.1573

### Save Place

O'ahu - 808.999.SAFE (7233) • Hawai'i - 808.959.5855

### Transition & Aftercare Support Services (TASS)

O'ahu & Kaua'i - 808.589.1829 Ext. 200

Hawai'i & Maui - 808.969.1935

### Wraparound Services

O'ahu - 808.589.1829 Ext. 200 • Hawai'i - 808.854.9032

### Youth Outreach (YO!)

O'ahu - 808.942.5858

## CLINICAL SERVICES

### Expanded Crisis Support (ECS)

O'ahu - 808.589.1829 Ext. 400 • Hawai'i - 808.969.1935

### Intensive In-Home Services (IiH) /

### Intensive Independent Living Skills (IILS)

O'ahu - 808.589.1829 Ext. 400

Kaua'i - 808.589.1829 Ext. 200 • Hawai'i - 808.969.1935

### Trafficking Victim Assistance Program (TVAP)

O'ahu, Kaua'i, Hawai'i Hotline - 1.888.398.1188

### Transitional Family Homes (TFH)

O'ahu - 808.589.1829 Ext. 115 • Hawai'i - 808.969.1935

## FAMILY SERVICES

### 'Ohana Resilience Support Services (ORSS) at Hale Kū Ola

O'ahu - 808.589.1829 Ext. 600

## MISSION STATEMENT

*Hale Kipa provides opportunities and environments that strengthen and encourage youth, their families and communities to actualize their potential and social responsibility.*

Hale Kipa is a multi-service, fully accredited 501(c)(3) nonprofit agency that specializes in working with youth and their families who often have nowhere else to turn. Hale Kipa has served more than 74,000 youth throughout Hawai'i since its beginning in 1970 as a single shelter on O'ahu.

This includes working in partnership with public agencies and private organizations to provide residential, outreach, and foster care services at no cost. With programs that are flexible and responsive to changing needs, Hale Kipa supports youth involved in juvenile justice, behavioral health, education and child welfare. Program goals include stabilizing young people in crisis and helping youth and families build resiliency to experience success in their lives. Services are flexible, free, creative, and determined by the youth's and family's needs.

All persons are treated equitably and without favoritism, subject to limitations imposed by contractual obligations.



# HALE KIPA

91-2128 Old Fort Weaver Road • 'Ewa Beach, HI 96706

T 808.589.1829 • F 808.589.2610

info@halekipa.org • www.halekipa.org



Aloha United Way  
Kauai United Way  
Hawaii Island United Way



# Emergency Shelter Services



# HALE KIPA

Empowering Lives - One Youth At A Time

## Emergency Shelter (ES) Services

Hale Kipa operates several types of shelters on O‘ahu offering emergency services for youth through age 17. Our shelters are open to youth who have been abused, or are neglected, unsheltered, or facing a personal crisis.

Our **Girls Emergency Shelter** houses eight females at a time, ages 12 through 17.

Our **Boys Emergency Shelter** houses eight males at a time, ages 12 through 17.

**Kamala Homes (KH)** are temporary emergency foster homes on O‘ahu that provide services to youth ages 12 through 17 who may best be served in a home setting. Kamala Home parents are licensed and trained by Hale Kipa.

Hale Kipa’s **Hale Ho‘opakele** on O‘ahu is open to youth ages 12 through 17 who are victims/survivors of commercial sexual exploitation and/or sex trafficking.

All of our emergency shelters accept self-referrals as well as referrals from Child Protective Services, Family Court, parents, and youth agencies.

## Population and Eligibility Criteria

- Youth ages 12 through 17
- Physical and TB clearances
- Youth Responsibilities
- Participate in program activities
- Participate in supportive services (groups, recreation, etc.)
- Attend an educational program
- Youth (and family) willing to comply with program expectations



## Services

- 24-hour support
- Strength-based individual, group and family counseling
- Educational support
- Coordinating services with schools and social service providers
- “Time out” for youth and family
- Structured and supervised living environment
- Skill building sessions
- Recreational activities
- Nutritious meals
- Community linkages

## Contact Information

ES / KH – 808.754.9844

Hale Ho‘opakele – 808.589.1829 Ext. 111

*“Every other place I’ve been has treated me like I’m a number. That’s why I left before. Here I feel like people care about how I am and not just filling out paperwork.”*

*Jake*

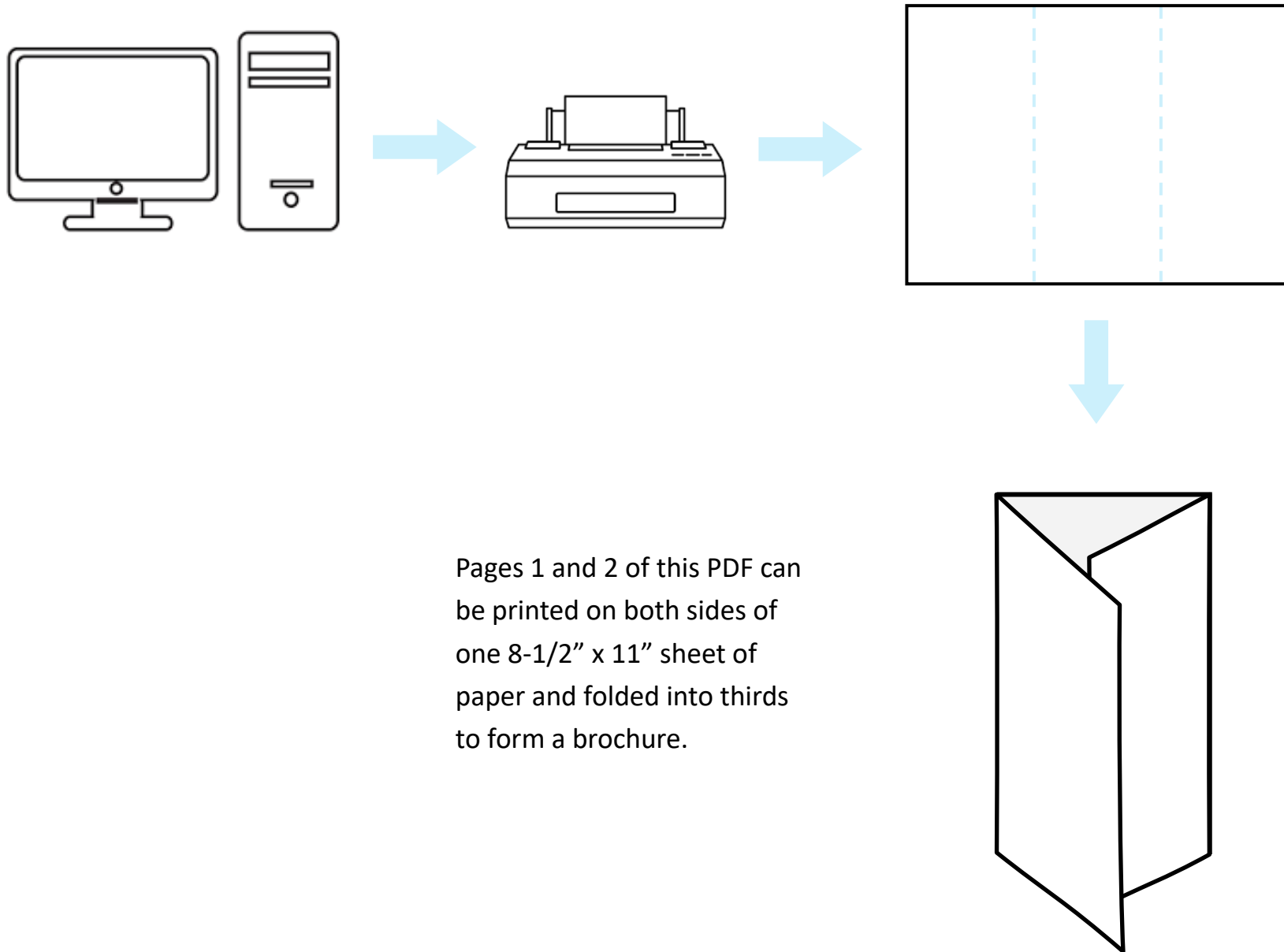

Pages 1 and 2 of this PDF can be printed on both sides of one 8-1/2" x 11" sheet of paper and folded into thirds to form a brochure.