

RESIDENTIAL SERVICES

Emergency Shelters (ES) / Kamala Homes (KH)

O'ahu - 808.754.9844

Hale Ho'opakele

O'ahu - 808.589.1829 Ext. 111

Hāloa House

Independent Living Program Training Home (ILPTH) Transitional Living Program (TLP)

O'ahu - 808.589.1829 Ext. 134

Kauhale 'Ōpio

O'ahu - 808.589.1829 Ext. 299

PREVENTION & OUTREACH SERVICES

Community-Based Outreach & Advocacy Programs (CBOA)

O'ahu & Kaua'i - 808.589.1829 Ext. 200

Guide On The Side (GOTS)

O'ahu - 808.265.0635

Ho'okala Attendant Care Program

O'ahu - 808.589.1829 Ext. 160

Independent Living Programs / Higher Education / Imua Kākou (IH)

Step-Up Housing & Foster Youth to Independence (FYI)

O'ahu - 808.589.1829 Ext. 233

Ka'i Like Program

O'ahu - 808.589.1829 Ext. 200 • Hawai'i - 808.969.1935

Kalihi Juvenile Assessment Center (KJAC)

O'ahu - 808.336.1573

Save Place

O'ahu - 808.999.SAFE (7233) • Hawai'i - 808.959.5855

Transition & Aftercare Support Services (TASS)

O'ahu & Kaua'i - 808.589.1829 Ext. 200

Hawai'i & Maui - 808.969.1935

Wraparound Services

O'ahu - 808.589.1829 Ext. 200 • Hawai'i - 808.854.9032

Youth Outreach (YO!)

O'ahu - 808.942.5858

CLINICAL SERVICES

Expanded Crisis Support (ECS)

O'ahu - 808.589.1829 Ext. 400 • Hawai'i - 808.969.1935

Intensive In-Home Services (IH) /

Intensive Independent Living Skills (IILS)

O'ahu - 808.589.1829 Ext. 400

Kaua'i - 808.589.1829 Ext. 200 • Hawai'i - 808.969.1935

Trafficking Victim Assistance Program (TVAP)

O'ahu, Kaua'i, Hawai'i Hotline - 1.888.398.1188

Transitional Family Homes (TFH)

O'ahu - 808.589.1829 Ext. 115 • Hawai'i - 808.969.1935

FAMILY SERVICES

'Ohana Resilience Support Services (ORSS) at Hale Kū Ola

O'ahu - 808.589.1829 Ext. 600

MISSION STATEMENT

Hale Kipa provides opportunities and environments that strengthen and encourage youth, their families and communities to actualize their potential and social responsibility.

Hale Kipa is a multi-service, fully accredited 501(c)(3) nonprofit agency that specializes in working with youth and their families who often have nowhere else to turn. Hale Kipa has served more than 74,000 youth throughout Hawai'i since its beginning in 1970 as a single shelter on O'ahu.

This includes working in partnership with public agencies and private organizations to provide residential, outreach, and foster care services at no cost. With programs that are flexible and responsive to changing needs, Hale Kipa supports youth involved in juvenile justice, behavioral health, education and child welfare. Program goals include stabilizing young people in crisis and helping youth and families build resiliency to experience success in their lives. Services are flexible, free, creative, and determined by the youth's and family's needs.

All persons are treated equitably and without favoritism, subject to limitations imposed by contractual obligations.

Community-Based Outreach and Advocacy Program



HALE KIPA

91-2128 Old Fort Weaver Road • 'Ewa Beach, HI 96706

T 808.589.1829 • F 808.589.2610

info@halekipa.org • www.halekipa.org



Aloha United Way
Kauai United Way
Hawaii Island United Way



HALE KIPA

Empowering Lives - One Youth At A Time

Community-Based Outreach and Advocacy Program (CBOA)

Hale Kipa's Community-Based Outreach & Advocacy Programs on O'ahu and Kaua'i provides strategic outreach and linkages to build community relationships with youth and young adults ages 10 through 21 and their families. Educational support, skill building, advocacy and case management services are also provided. Services are provided for up to 18 months.

Population and Eligibility Criteria

- O'ahu and Kaua'i
- Youth ages 10 through 21
- Anyone may refer

Discharge Criteria

- Youth / family achieves goals
- Youth ages out or otherwise becomes ineligible for services

Youth and Family Responsibilities

- Participation in the development of an individualized service plan and personal goals
- Participate in goal-specific program activities

CBOA Services

- Outreach to youth and families
- Assessments
- Individualized service plan address:
 - Improved school performance
 - Improved family relationship
 - Improved independent living skills
 - Reduced juvenile justice system involvement
 - Decreased substance abuse
 - Employment
- Individual and family support at hours convenient for youth and families
- Advocacy and referrals
- Competency development for youth and parents
- Development of circle of support
- Linkages and collaboration with other community resources
- 24-hour staff accessibility

Contact Information

O'ahu & Kaua'i – 808.589.1829 Ext. 200



“For us kids who are less fortunate, we struggle, we go through things. We must choose the route that we think is going to help us. Hale Kipa really supported me with that.”

Pi'lani

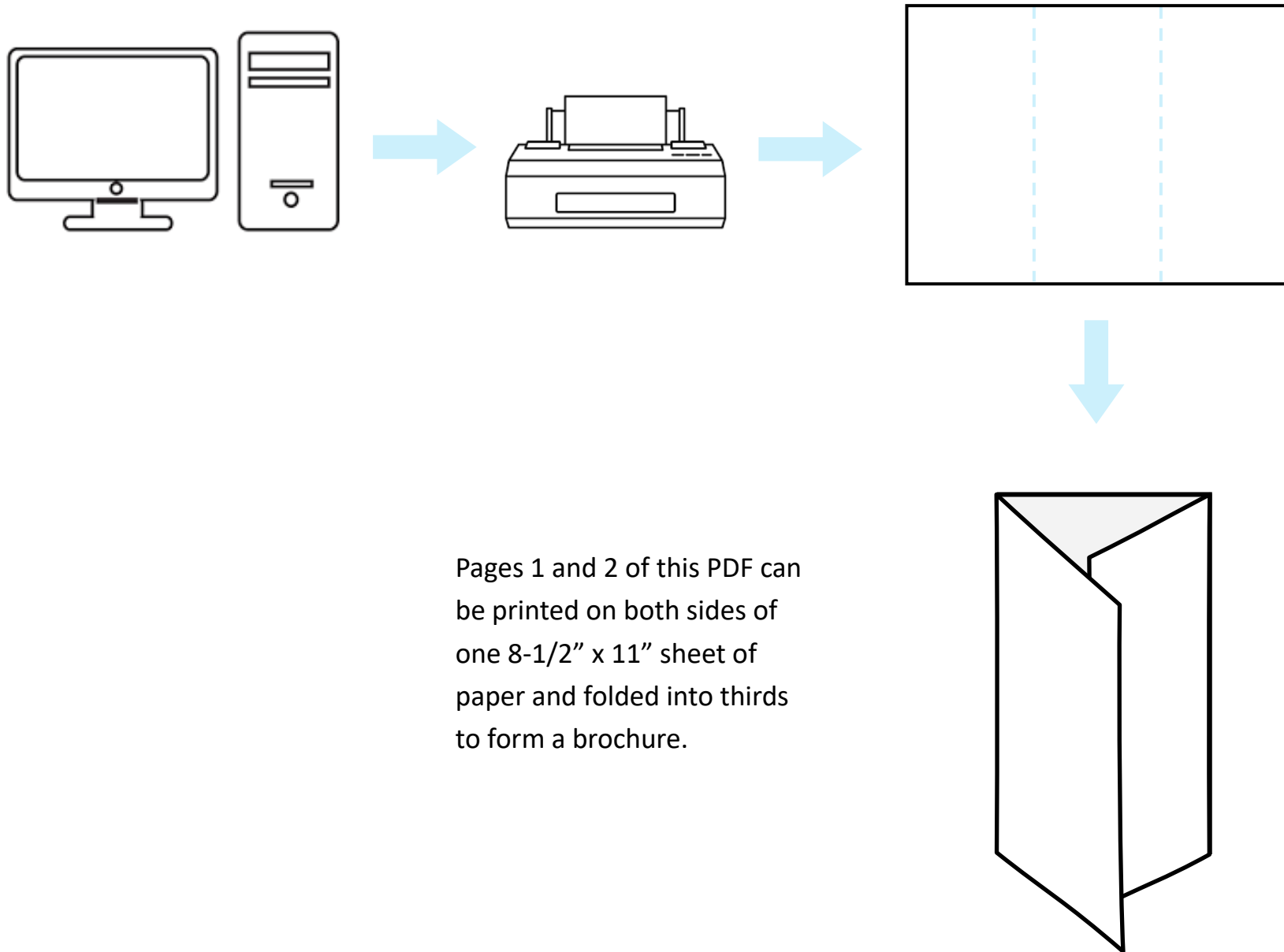

Pages 1 and 2 of this PDF can be printed on both sides of one 8-1/2" x 11" sheet of paper and folded into thirds to form a brochure.