

## RESIDENTIAL SERVICES

### Emergency Shelters (ES) / Kamala Homes (KH)

O'ahu - 808.754.9844

### Hale Ho'opakele

O'ahu - 808.589.1829 Ext. 111

### Hāloa House

### Independent Living Program Training Home (ILPTH)

### Transitional Living Program (TLP)

O'ahu - 808.589.1829 Ext. 134

## PREVENTION & OUTREACH SERVICES

### Community-Based Outreach & Advocacy Programs (CBOA)

O'ahu & Kaua'i - 808.589.1829 Ext. 200

### Guide On The Side (GOTS)

O'ahu - 808.265.0635

### Ho'okala Attendant Care Program

O'ahu - 808.589.1829 Ext. 160

### Independent Living Programs / Higher Education / Imua Kākou ('IHI)

### Step-Up Housing & Foster Youth to Independence (FYI)

O'ahu - 808.589.1829 Ext. 233

### Ka'i Like Program

O'ahu - 808.589.1829 Ext. 200 • Hawai'i - 808.969.1935

### Kalihi Juvenile Assessment Center (KJAC)

O'ahu - 808.336.1573

### Save Place

O'ahu - 808.999.SAFE (7233) • Hawai'i - 808.959.5855

### Transition & Aftercare Support Services (TASS)

O'ahu & Kaua'i - 808.589.1829 Ext. 200

Hawai'i & Maui - 808.969.1935

### Wraparound Services

O'ahu - 808.589.1829 Ext. 200 • Hawai'i - 808.854.9032

### Youth Outreach (YO!)

O'ahu - 808.942.5858

## CLINICAL SERVICES

### Expanded Crisis Support (ECS)

O'ahu - 808.589.1829 Ext. 400 • Hawai'i - 808.969.1935

### Intensive In-Home Services (IiH) / Intensive Independent Living Skills (IILS)

O'ahu - 808.589.1829 Ext. 400

Kaua'i - 808.589.1829 Ext. 200 • Hawai'i - 808.969.1935

### Trafficking Victim Assistance Program (TVAP)

O'ahu, Kaua'i, Hawai'i Hotline - 1.888.398.1188

### Transitional Family Homes (TFH)

O'ahu - 808.589.1829 Ext. 115 • Hawai'i - 808.969.1935

## FAMILY SERVICES

### 'Ohana Resilience Services (ORS) at Hale Kū Ola

O'ahu - 808.589.1829 Ext. 603

## MISSION STATEMENT

*Hale Kipa provides opportunities and environments that strengthen and encourage youth, their families and communities to actualize their potential and social responsibility.*

Hale Kipa is a multi-service, fully accredited 501(c)(3) nonprofit agency that specializes in working with youth and their families who often have nowhere else to turn. Hale Kipa has served more than 74,000 youth throughout Hawai'i since its beginning in 1970 as a single shelter on O'ahu.

This includes working in partnership with public agencies and private organizations to provide residential, outreach, and foster care services at no cost. With programs that are flexible and responsive to changing needs, Hale Kipa supports youth involved in juvenile justice, behavioral health, education and child welfare. Program goals include stabilizing young people in crisis and helping youth and families build resiliency to experience success in their lives. Services are flexible, free, creative, and determined by the youth's and family's needs.

All persons are treated equitably and without favoritism, subject to limitations imposed by contractual obligations.

# Hale Kū Ola

## 'OHANA RESILIENCE SERVICES



## HALE KIPA

91-2128 Old Fort Weaver Road • 'Ewa Beach, HI 96706

T 808.589.1829 • F 808.589.2610

info@halekipa.org • www.halekipa.org



Aloha United Way  
Kauai United Way  
Hawaii Island United Way



## HALE KIPA

Empowering Lives - One Youth At A Time

## ‘Ohana Resilience Services (ORS) at Hale Kū Ola

At ‘Ohana Resilience Services, located within the warm embrace of Hale Kū Ola, we are committed to strengthening families and empowering them to overcome life's challenges. Our family strengthening program focuses on cultivating resilience, nurturing healthy relationships, and fostering growth within the family. We are dedicated to supporting families and individuals in our community by offering a range of programs and services designed to enhance well-being, promote healthy relationships and foster growth. Our center is a safe and welcoming space where you can find the resources and assistance you need to flourish.

### Services

At the core of our programs is the belief that strong families are the foundation of our communities, particularly in this district of ‘Ewa. We utilize a holistic approach that recognizes the unique qualities of each parent and ‘ohana circumstance and the importance of cultural sensitivity. By building upon existing strengths and providing supports based on these strengths, we help families navigate difficult and uncertain times and circumstances, with the intent of helping families emerge stronger.

### Services We Offer

**‘Ohana Success Coaching** - Our experienced and compassionate Success Coaches are here to listen, guide and provide the supports necessary to work through and overcome stressful situations. Whether facing communication

issues, transitions, or unexpected stressors, our restorative sessions offer a safe space for growth and healing. We understand that life can sometimes be challenging. We offer opportunities for growth in the areas of: building resilience through managing stress, coping skills and problem solving techniques so that you become better equipped to navigate your way through adversity.

### Parent-Child Relationship Enhancement -

Strengthening the bond between parents and children is key to your ‘ohana well-being, and comes with the understanding that you are your child's first teacher.

### Parenting Classes

- We offer Kamalama Parenting curriculum, a metaphoric values-based model. Authored by Hale Kipa CEO, Venus Rosete-Medeiros. Kamalama, meaning “the light,” is designed to be a 10 week course, with each class session incorporating Hawaiian values and parenting principles together.

### Cultural Engagement

- Embracing and celebrating cultural heritage is vital to the ‘ohana identity. We integrate cultural activities, traditions and teachings to reinforce the importance of cultural roots that creates a sense of belonging for each family member.

### Emergency Shelter Services

- Emergency shelter services for single mothers or single fathers up to two families at a time, is a crucial support to families experiencing homelessness or crisis situations. This service is aimed to ensure the safety, protection, and stability of the ‘ohana as they navigate through difficult, yet temporary circumstances.

**Community Engagement** - We believe in the strength of community connections. We help to facilitate networking events, family strengthening activities, gatherings and collaborative projects that promotes a community where families can share experiences and resources.

### Contact Information

O‘ahu – 808.589.1829 Ext. 603

91-1259 Renton Road

‘Ewa Beach, Hawai‘i 96706



*“It takes a village to raise a child.  
‘Ohana Resiliency Services brings the  
village together and supports our family  
to lead my teenager towards success.”*

*JM (mother)*

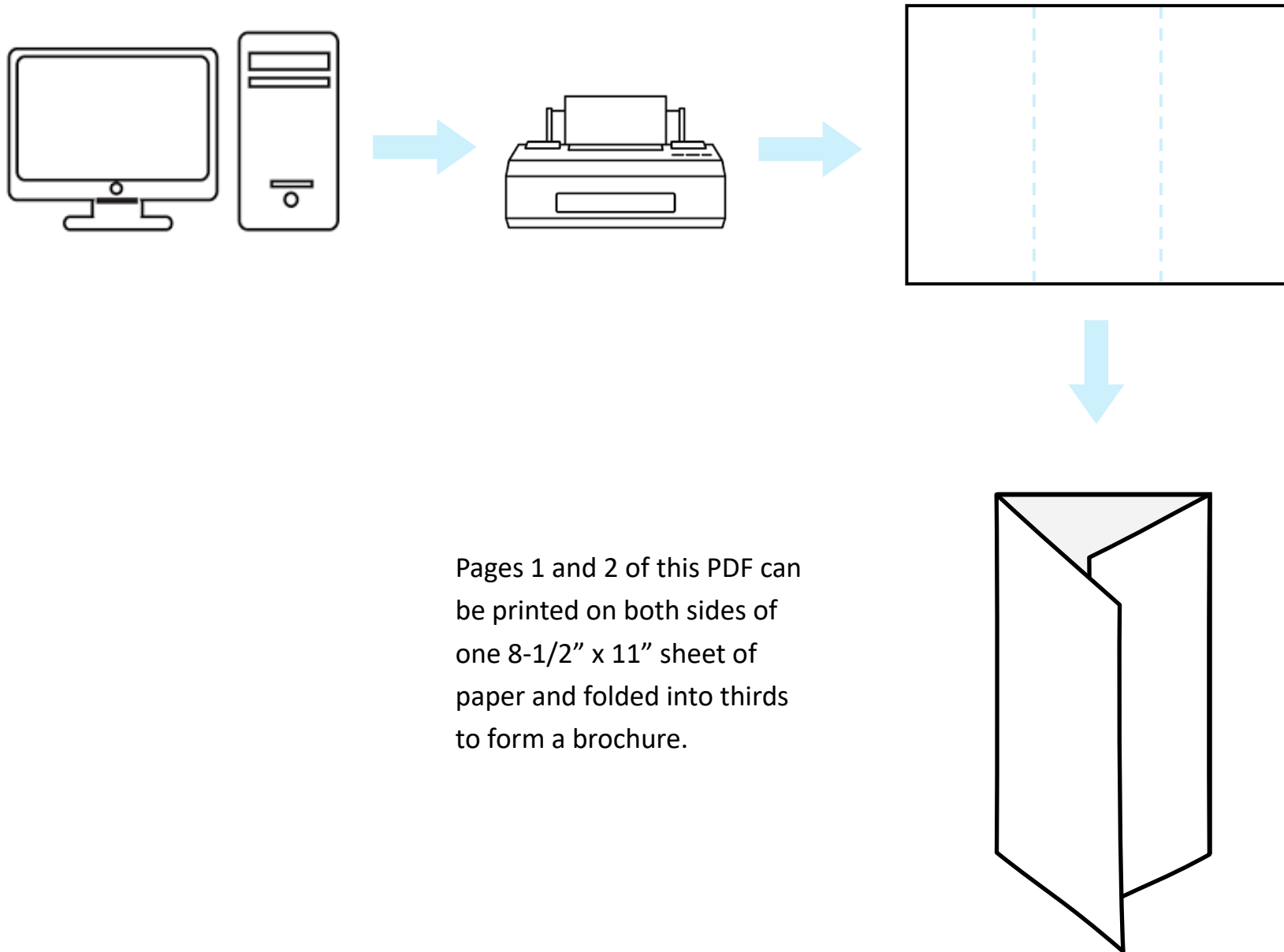

Pages 1 and 2 of this PDF can be printed on both sides of one 8-1/2" x 11" sheet of paper and folded into thirds to form a brochure.